

WHEELED LITTER CARRIER: EL3000 INSTRUCTION MANUAL



NSN 6530-01-591-9636
FareTec Inc. CAGE Code: 0R123
www.FareTec.com
Training Video Available online



LITTER CARRIER EL3000

USAGE:

The Wheeled Litter Carrier (WLC) is designed for transporting patients with one or two bearers over many types of surfaces. It is also useful for transporting supplies and equipment. It has been equipped with large flat free wheels. No pump is ever necessary. It had been designed to accommodate all litter types and sizes.

When the legs are in their locked position; the litter carrier can be a stable platform/work station for patient aid. When the WLC is not in use, it can be closed quickly to save space. The device can be opened and setup in approx. 30 seconds.

PREPARATION :

1.) Release buckle on top of carrier between the tires. Squeeze the side clips together and pull apart.



2.) Raise the handles into their operating position by pulling them away from the carrier, then lifting them up. They will lock in place, parallel to the floor.

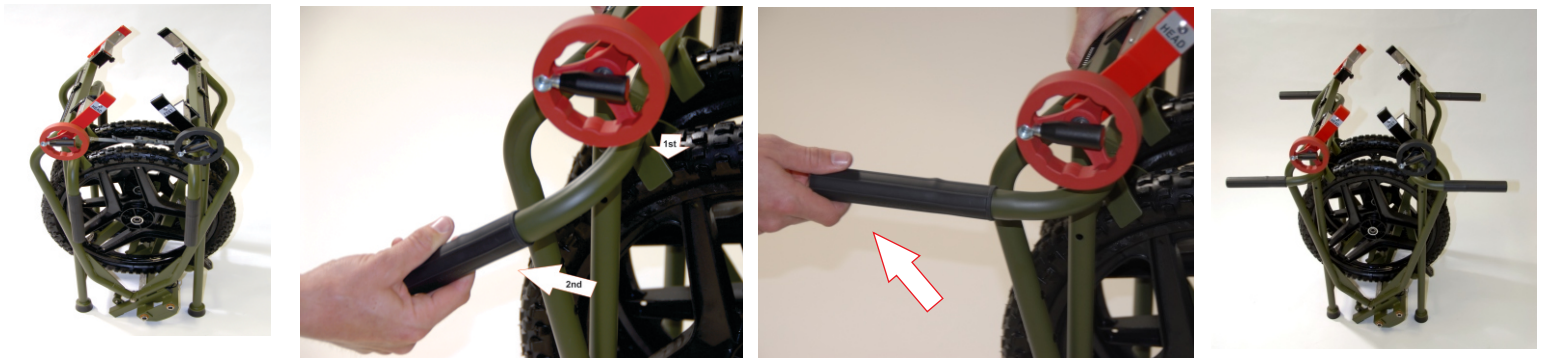

3.) Stand alongside the carrier, grip each side of the unit between the clamps and push the two sides away from each other. Remove the wheels and place them nearby with the pins facing up, clear of debris. Engage the two sides of the carrier by forcefully pushing down until a “click” sound is heard and the two sides are locked in place.

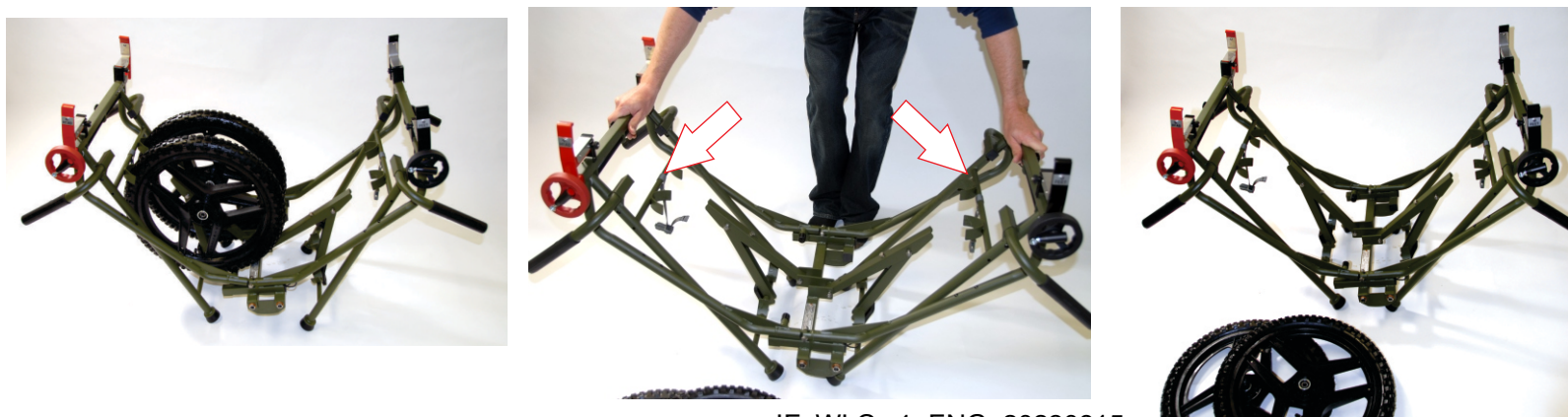

STABILIZE LITTER CARRIER:

To engage the legs, grab the handles on one side of the carrier and lift them upwards towards your chest. This will swing the legs into their static position. Lift until the stabilization bar “snaps” into place. Do the same on the other side.



LOCK WHEELS ONTO CARRIER:

Align axle pin inside wheel hub with bushing hole* on the side of the carrier. Insert pin by simply pushing the wheel and the pin into bushing hole. Repeat on other side.

Note: For normal use, the OFF CENTER pin housing SHOULD be used to allow the litter to transport patients in a more stable mode. (See Green square and arrow) This is also necessary for easier transport on difficult terrain. The pin housing located along the center axle rod (as shown) should only be used in a hospital setting, with two bearers.

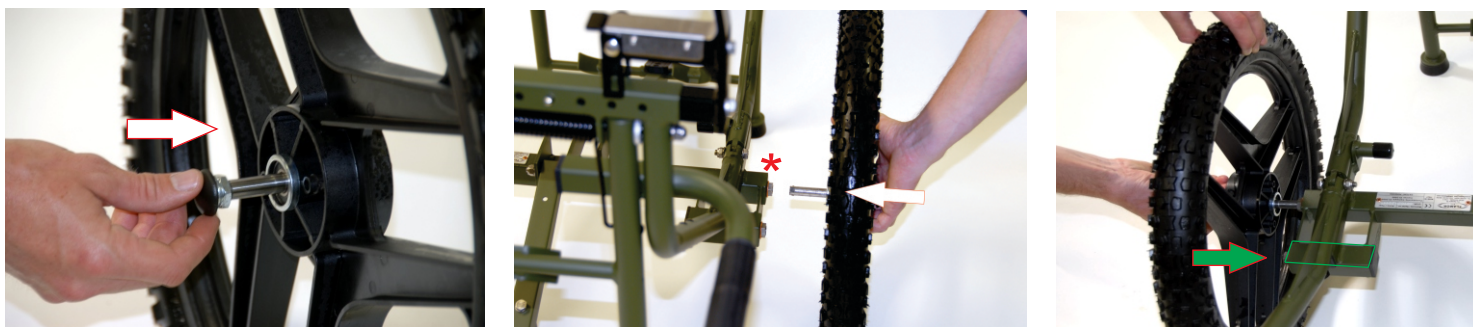

ENGAGE LITTER WITH THE CARRIER:

The pin on the red and black hand wheels should be pulled out so that the wheel can be spun quickly (see below). The patient/litter should be placed near the middle of the carrier, so that the weight distribution is even on both ends of the WLC. Once the litter is placed on the WLC, these handwheels should be spun clockwise until the clamps are tight around both sides of the Litter. The patient’s head should always be at the RED side of the WLC. To remove the Litter, spin both hand wheels counter-clockwise. The pin should then be folded back into the handwheel.



TRANSPORT MODE:

Both pairs of legs must be folded underneath the WLC for it to be transported safely. The pair of legs under the patient's feet must be folded in first. This is done by gently lifting the litter's handles with both hands while at the same time pressing your foot against the release pedal. This process can then be repeated on the side of the patient's head. Once both pairs of the WLC legs are folded in, the unit is ready for transport. The use of two bearers is recommended, however the EL3000 can also be transported by just one person. In this case, the bearer should position himself on the side by the patient's head, next to the RED clamps.

TRANSPORT WITHOUT LITTER:

Move the WLC, without a stretcher by folding both pairs of legs alongside the unit. Hold the handles on one side. The device is now ready to be used as a wheelbarrow to transport goods/equipment.

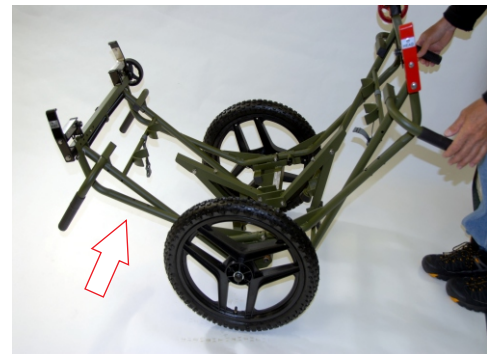

DISASSEMBLY AND STORAGE:

- 1.) Remove wheels; push the button positioned at the center of the wheel as you're pulling the wheel away from the WLC. Place the wheels nearby, with the pins facing up.
- 2.) Close a pair of legs by pressing the foot release pedal while lifting the handles gently. Repeat on the other side of the WLC.(not shown)
- 3.) Move to the side of the WLC and grab both ends between the colored litter clamps. Pull the two ends towards each other with force to disengage the lock.
- 4.) Position the two wheels in the housing slots. Make sure the pins are facing outward.
- 5.) Make sure the wheels are correctly positioned as you finish pulling closed the two sides of the WLC. Fasten the strap and tighten.
- 6.) Pull each of the handles away from the WLC and twist towards the ground. They will engage again in a downward position.

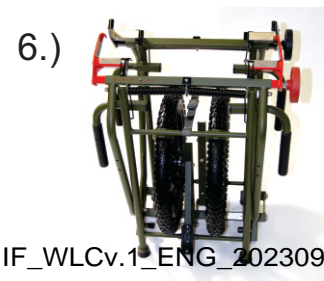
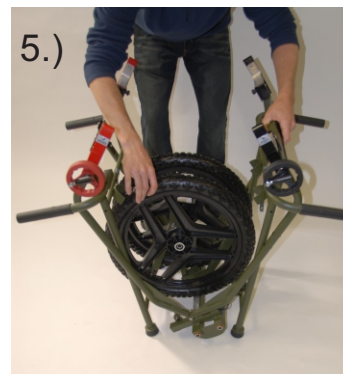
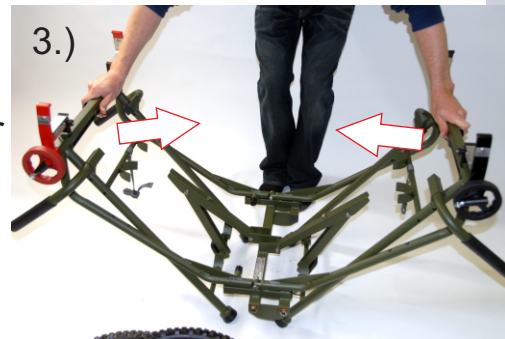
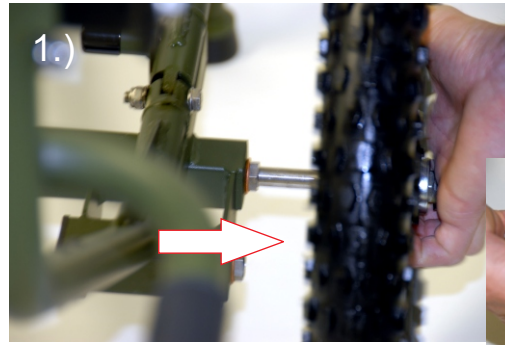

MAINTENANCE & WARRANTY:

The materials used for the EL3000 have been selected and tested at our facility. In addition, this device was rigorously tested at the US ARMY testing facility at Ft. Detrick MD. It has been named the Joint Product of Choice (JPOC) for the Wheeled Litter Carrier as deemed by the Defense Medical Material Program Office (DMMPO).

This product is under a limited warranty for a 2 year period from the date of sale. This warranty covers any defects or malfunctions in your new EL3000 WLC. Any defect which could have been avoided by the manufacturer will be repaired or replaced at the cost of FareTec Inc. This warranty does not cover breakdowns that have occurred through unforeseen circumstances during normal use.

Considering the extreme environmental conditions the device may encounter, maintenance will be necessary. General cleaning and inspection of the WLC will address most issues. If problems occur, we ask you to contact FareTec Inc. to address an anomaly, fault or rapid wear of it's components. We will proceed to respond to the issue in the most reasonable manner to ensure the working status of your WLC.

A key element to maintaining your EL3000 is keeping your axle pins and bearings clean. The pins should always be left in the wheels, unless they are being cleaned. When assembling and disassembling, the wheels should be kept nearby, with the axle pins pointed up; out of the dirt and away from debris. The bearings and pins should be routinely inspected and cleaned. This can be done using basic cleaning supplies and lubricants.

-Replacement Wheel	Part # 2221024	FareTec Inc.
-Replacement Pin	Part # 2221025	NSN 6530-01-591-9636
-Paint touch-up/Repair Kit	Part # 2221026	CAGE Code: 0R123

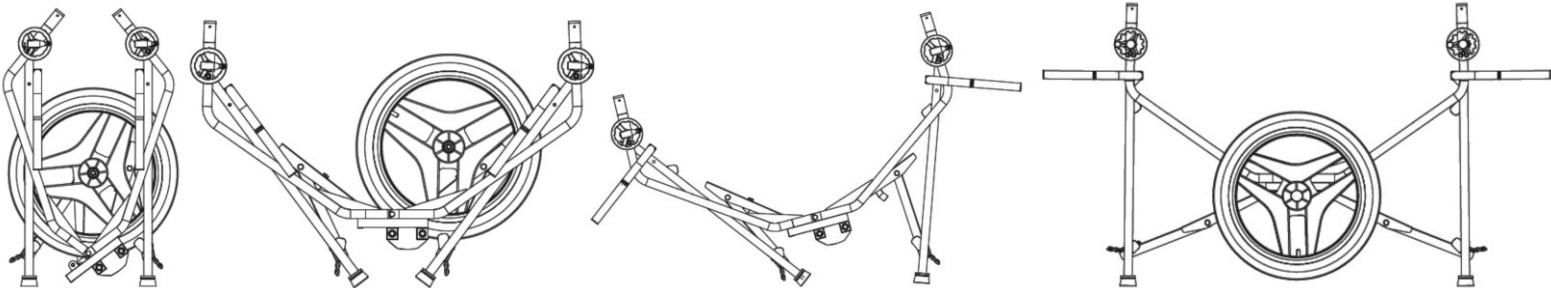

FareTec Inc.
1610 West Jackson St. Unit 6
Painesville OH 44077
USA
440 350 9510
f.440 350 9520
www.FareTec.com

